

CHELSEA® 660 SERIES

Two Gear Heavy Duty PTO for Mechanical Transmission

The Chelsea 660 PTO features a cast iron housing, cast iron bearing caps, and a press fit idler pin with tapered cone bearings and one-piece input gears to give it the highest torque rating and longest service life possible. The space saving air shift cover provides maximum clearance in tight spaces. It offers a large variety of output options including Chelsea's popular 360° rotatable and greaseable pump mount options. It has four internal speed ratios and multiple shift options to make this one versatile PTO. Take advantage of Chelsea PTO technology to increase performance and lower costs.

Applications:

- Aerial
- Fire & Rescue
- Dump Trucks & Trailers
- Service Trucks
- Blower & Vacuum

Product Features and Benefits:

- Coverage – Excellent for 6-Bolt Transmissions.
- Torque – Designed for higher torque applications such as pneumatic blowers.
- Speeds – Several speed ratios to choose from.
- Outputs – Numerous output options.
- Shift Options – Multiple shift options.
- Power – Torque ratings up to 375 lb-ft.
- Confidence – Two year warranty.

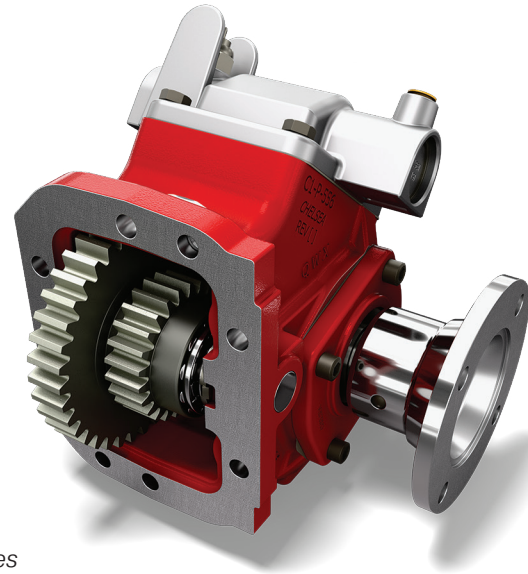

660 Series



660 Series Power Take-Off – Multiple Transmission Options

Model Number Designator

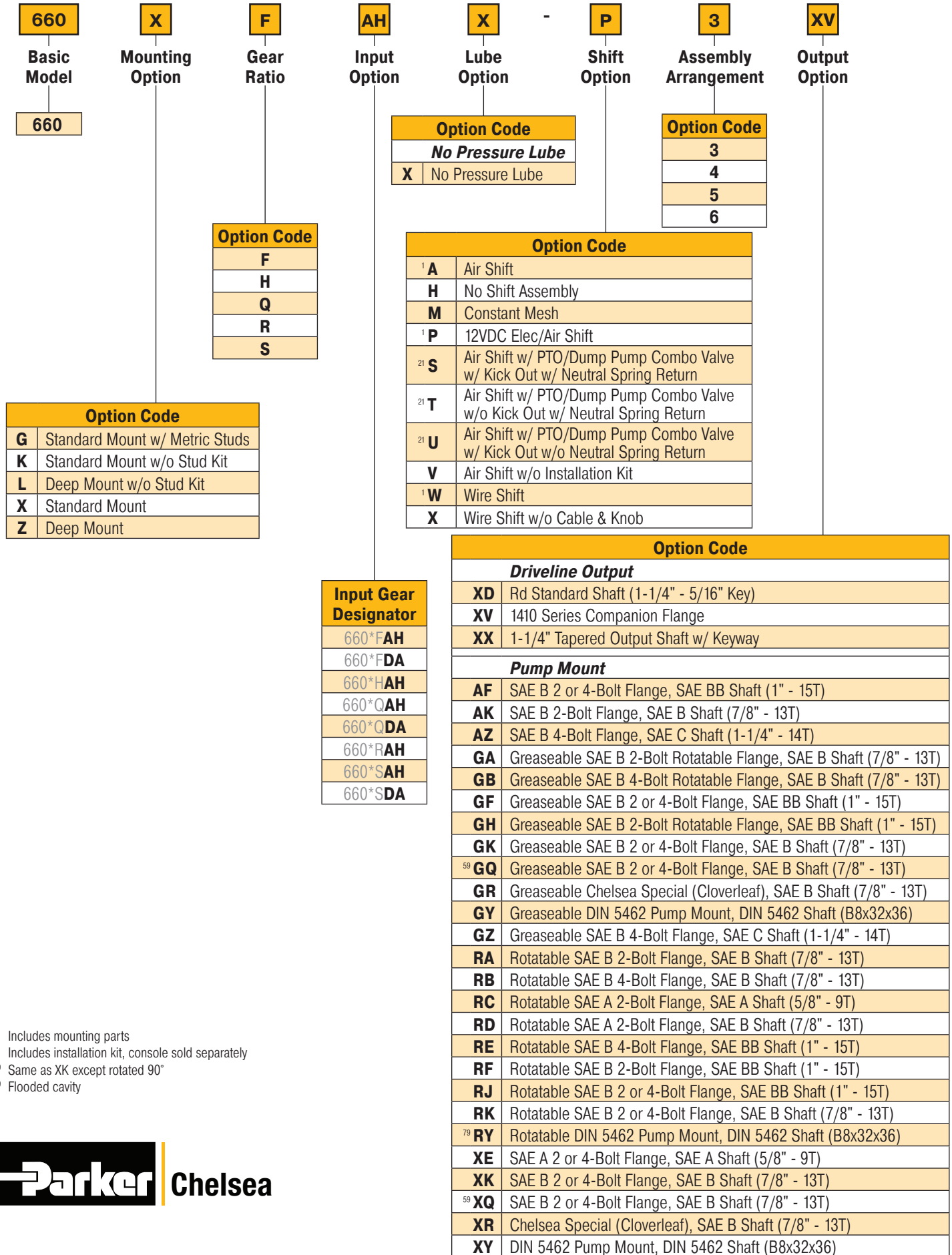

¹ Includes mounting parts

²¹ Includes installation kit, console sold separately

⁵⁹ Same as XK except rotated 90°

⁷⁹ Flooded cavity

660 Series Power Take-Off – Multiple Transmission Options

Dimensions & Specifications – For PTO output information see application catalog

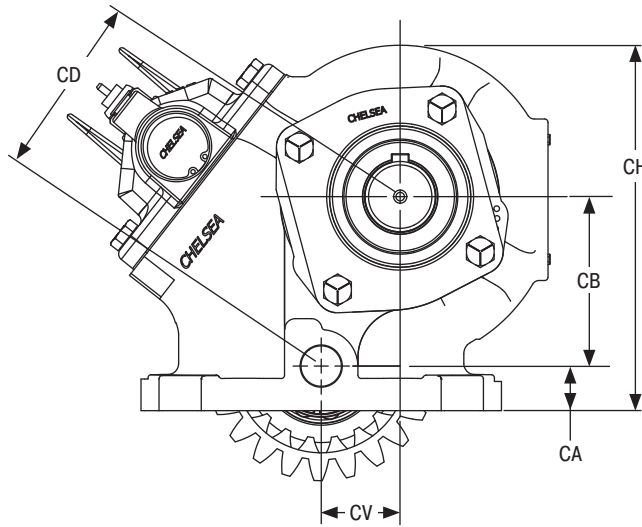

PTO Series	Part Number	CA	CB	CD	CH	CV
660 Standard	1-P-580	0.79"	3.01" (F, S, U)	3.32" (F, S, U)	6.43"	1.40" (F, S, U)
			2.91" (Q, W)	3.09" (Q, W)		1.03" (Q, W)
660 Deep Mount	1-P-581	0.57"	3.01" (F, S, U)	3.32" (F, S)	6.21"	1.40" (F, S, U)
			2.91" (Q, W)	3.09" (Q, W)		1.03" (Q, W)

Specifications Chart	Approximate Weight: 28.2 lbs. [12.8 kg]				
	660*F	660*H	660*Q	660*R	660*S
Intermittent Torque Rating lb-ft [N-m]	375 [508]	375 [508]	375 [508]	350 [475]	325 [441]
HP Rating for Intermittent Service					
At 500 RPM of Output Shaft HP [kW]	36 [27]	36 [27]	36 [27]	33 [25]	31 [23]
At 1000 RPM of Output Shaft HP [kW]	71 [53]	71 [53]	71 [53]	67 [50]	62 [46]
At 1500 RPM of Output Shaft HP [kW]	107 [80]	107 [80]	107 [80]	100 [75]	93 [69]

Parker Hannifin Corporation
Chelsea Products Division
 8225 Hacks Cross Road
 Olive Branch, MS 38654 USA
 phone 1-888-PH4-TRUK (1-888-744-8785)
 chd_support@support.parker.com
 www.parker.com/chelsea

HY25-0097-B1/US November 2025

© 2025 Parker Hannifin Corporation

